

FOR GENERAL NOTES REFER DRAWING S0.01
 DWG's. TO BE READ IN CONJUNCTION WITH ARCHITECTURALS.
 ALL CONC. PROFILES i.e. STEPS, FALLS, ETC. TO ARCH. DETAIL

MEMBER SCHEDULE

MARK	MEMBER
(u)	INDICATES MEMBER IS UNDER
(o)	INDICATES MEMBER IS OVER ONLY
FB1	400dp x 400w RC FOOTING BEAM. 2N16 TOP & BTM, N12-300 TIES
FB2	350dp x 350w RC FOOTING BEAM. 2N12 TOP & BTM, N12-250 TIES
PF1	600 x 600 x 300dp PAD FOOTING. N12-200 EW BTM
BW1	190 R.C. BLOCKWALL. N16-400 E.W.
BW2	140 R.C. BLOCKWALL N12-400 E.W.
RW1-RW2	190 R.C. BLOCK RETAINING WALL. N16-400 E.W.
EB1	400dp MIN x 400w SLAB EDGE BEAM. 2N16 TOP & BTM, N12-300 TIES
EB2	350dp x 350w SLAB EDGE BEAM. 2N12 TOP & BTM, N12-250 TIES
EB3	300w x 300dp MIN SLAB EDGE BEAM. REFER DETAIL DRG S2.02
GB1	400dp x 400w SLAB BEAM. 2N16 TOP & BTM, N12-300 TIES
GB2	400dp MIN x 400w SLAB BEAM. 2N16 TOP & BTM, N12-300 TIES
C1	89 x 5 SHS STEEL COLUMN
C2	139.7 x 5.0 CHS STEEL COLUMN
C3	150 x 9.0 SHS STEEL COLUMN
C4	139.7 x 5.4 CHS STEEL COLUMN
1S	90 x 45 MGP10 STUD TIMBER POST
2S	2-90 x 45 MGP10 STUD TIMBER POST
3S	3-90 x 45 MGP10 STUD TIMBER POST
4S	4-90 x 45 MGP10 STUD TIMBER POST
DB1	200 PFC STEEL BEAM
L1	2-190 x 45 LVL TIMBER LINTEL
L2	100 x 8 EA STEEL LINTEL
L3	100 x 12 EA STEEL LINTEL (CURVE AS REQ'D)
L4	150 x 100 x 10 GALINTEL
L5	2-200 x 45 TIMBER LINTEL
RB1	2-170 x 45 LVL TIMBER BEAM
RB2	2-200 x 45 LVL TIMBER BEAM
RB3	2-240 x 45 LVL TIMBER BEAM
RB4	2-300 x 45 LVL TIMBER BEAM
RB5	250 x 150 x 12.5 RHS STEEL BEAM (CURVED AS REQ'D) (250 UB 37 IF STRAIGHT)
RB6	250 x 150 x 5 RHS STEEL BEAM (CURVED AS REQ'D) (200 UB 30 IF STRAIGHT)
RB7	2-240 x 45 LVL TREATED TIMBER BEAM AND SEALED OVER TOP FOR EXTERNAL USE
RB8	2-360 x 45 LVL TIMBER BEAM
RB9	2-190 x 45 MGP10 TIMBER BEAM. SEASONED AND TREATED TO H3 IF NOT FULLY WEATHER PROTECTED
RB10	2-190 x 45 MGP10 TIMBER BEAM. SEASONED AND TREATED TO H3 IF NOT FULLY PROTECTED
RB11	NOT USED
RB12	150 PFC
RB13	150 PFC
RB14	150 x 9.0 SHS
OR1	150 UB 14 STEEL OUTRIGGER FULLY WELDED TO COLUMN
R1	200 x 45 LVL TIMBER RAFTERS @ 600 CRS
R2	130 x 45 LVL TIMBER RAFTERS @ 600 CRS
R3	140 x 45 MGP10 TIMBER RAFTERS @ 600 CRS. SEASONED AND TREATED TO H3 IF NOT FULLY WEATHER PROTECTED
R4	190 x 45 MGP10 TIMBER RAFTERS @ 600 CRS. SEASONED AND TREATED TO H3 IF NOT FULLY WEATHER PROTECTED
R5	200 x 45 LVL TIMBER RAFTERS @ 600 CRS
R6	200 x 45 LVL TIMBER RAFTERS @ 450 CRS
R7	200 x 45 LVL TIMBER RAFTERS @ 450 CRS
R8	300 x 45 LVL TIMBER RAFTERS @ 450 CRS
R9	150 x 45 LVL TIMBER RAFTERS @ 600 CRS
R10	150 x 45 LVL TIMBER RAFTERS @ 600 CRS
R11	95 x 45 LVL TIMBER RAFTERS @ 600 CRS
R12	150 x 45 LVL TIMBER RAFTERS @ 500 CRS

- ALL LVL'S TO BE HYSPAN, smapLVL 15 OR APPROVED EQUIVALENT TYPICALLY.
- ALL DOUBLE TIMBER MEMBERS TO BE FULLY NAILED TOGETHER FOR THE FULL LENGTH - REFER TO THE TYPICAL VERTICAL LAMINATION DETAIL.
- ALL WALLS MARKED PBW ARE PLY BRACED WALLS WITH THE MINIMUM LENGTH IN METRES DENOTED IN BRACKETS.

FOR CONSTRUCTION

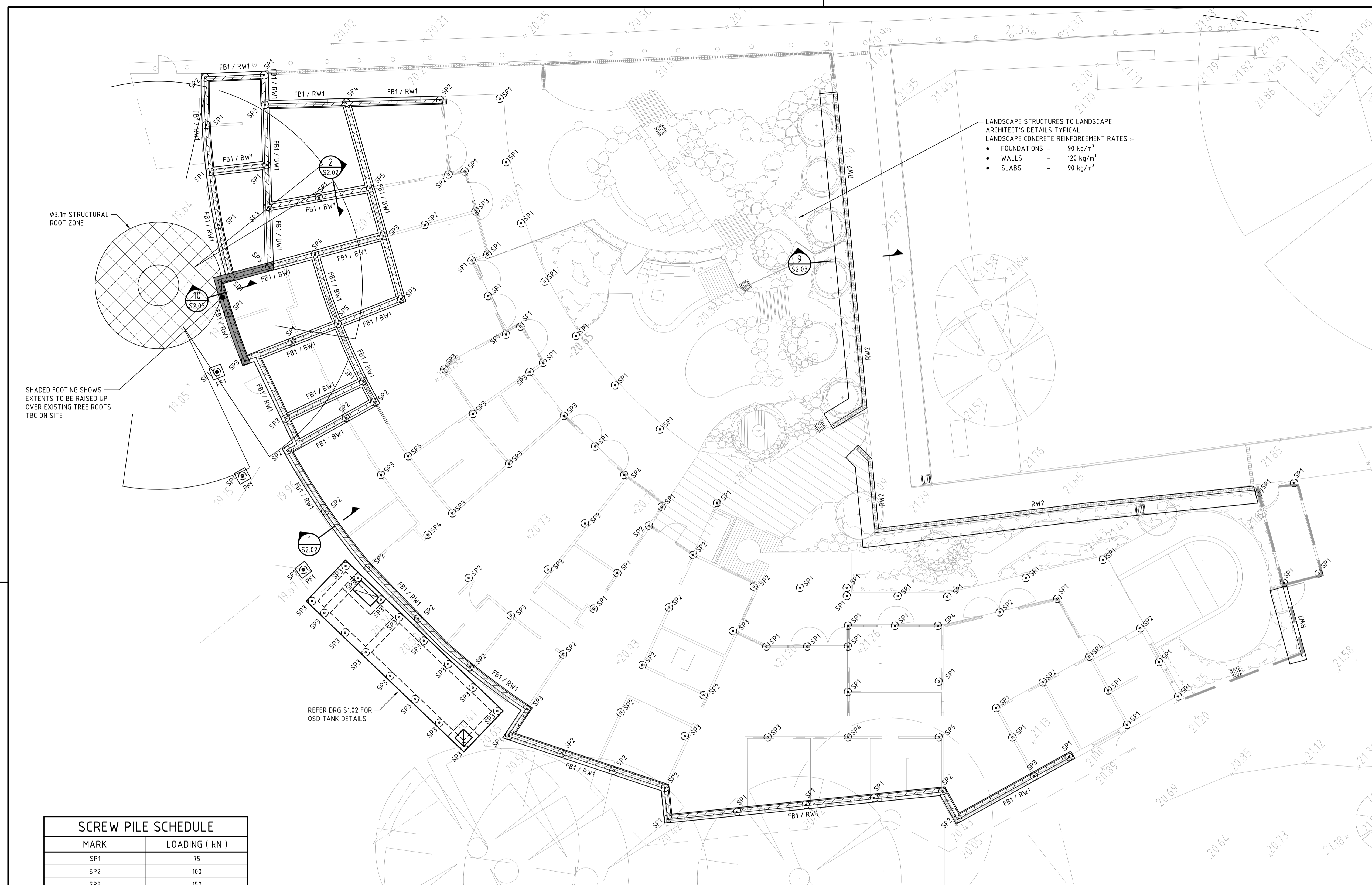

FOOTING PLAN

SCALE 1:100

⊙ DENOTES SCREW PILES @ 3500 CRS MAX. REFER SCREW PILE SCHEDULE

SCREW PILE SCHEDULE

MARK	LOADING (kN)
SP1	75
SP2	100
SP3	150
SP4	200
SP5	250

NOTE:

SCREW PILE SYSTEM DOCUMENTED WILL NEED TO BE VERIFIED ON SITE AS VIABLE TO ACHIEVE REQUIRED LOADS. REFER GEOTECH REPORT. ALTERNATIVE BORED PIER SYSTEM MAY BE REQUIRED IF SCREW PILE OPTION PROVES UNVIABLE.

ISSUE	AMENDMENT	DATE	CHECKED	ISSUE	AMENDMENT	DATE	CHECKED
D	ISSUED FOR CONSTRUCTION	07.08.15	K.M.				
C	RE-ISSUED FOR TENDER	16.04.15	K.M.				
B	ISSUED FOR INFORMATION	01.04.15	K.M.				
A	ISSUED FOR TENDER	18.02.15	K.M.				
P2	ISSUED FOR 75% TENDER	19.12.14	K.M.				
P1	ISSUED FOR 50% TENDER	08.12.14	K.M.				

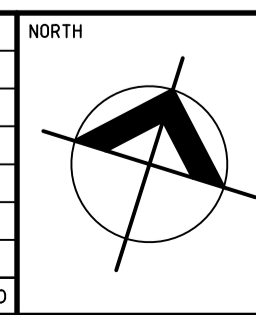

THIS DRAWING IS COPYRIGHT AND MUST NOT BE RETAINED, COPIED OR USED WITHOUT THE EXPRESS AUTHORITY OF SDA STRUCTURES PTY LTD. ONLY USE FIGURED DIMENSIONS. DO NOT SCALE DRAWINGS. ALL DISCREPANCIES TO BE REFERRED TO ENGINEER PRIOR TO CONSTRUCTION.

ARCHITECT
DILLON AND SAVAGE ARCHITECTS
 40 QUINTON ROAD, MANLY NSW, 2095
 T: (02) 9977 3714
 F: (02) 9977 8215
 E: dsarchs@bigpond.net.au

SDA SDA Structures Pty Ltd
 Consulting Engineers
 STUDIO 2
 61 VICTORIA ROAD
 ROZELLE NSW 2039
 T: (02) 9810 6911
 F: (02) 9810 6922
 E: sda@sdastructures.com.au

PROJECT
**PROPOSED CHILDCARE CENTRE
 LEICHHARDT PARK**

TITLE
FOOTING PLAN

JOB NUMBER	DRAWING NUMBER	REVISION
14-210	S1.01	D
DATE 13/02/13	SCALE @ A1 1:100	CERTIFIED <i>Karen Wang</i>
DESIGNED K.M.	DRAWN J.W.	